



GPS Watch Quick Guide



Press Menu and Enter button simultaneously

Button functions

| Button combinations | Functions |
|---|--|
| Short press the Power/Return button (Return function) | Returns to the previous page and the main menu |
| Long press the Power/Return button (Power off function) | Powers on or off the device |
| Short press the Menu button (Menu and menu selection function) | Enters the main menu or menu selections |
| Short press the Enter button (To enter or confirm) | Enters or confirms a selection |

Notice

Please note: Before inserting the SIM card to the device make sure you haven't set a password PIN code on your sim card. (PIN code may be enabled or disabled via your mobile phone).

Installing the SIM card and the battery

1. Push the SIM card into the SIM card slot and then lock the SIM card slot.
2. Connect the battery to the battery connector of the device.
3. Replace the back cover to **GPS watch** and secure it with screws and the plugs.

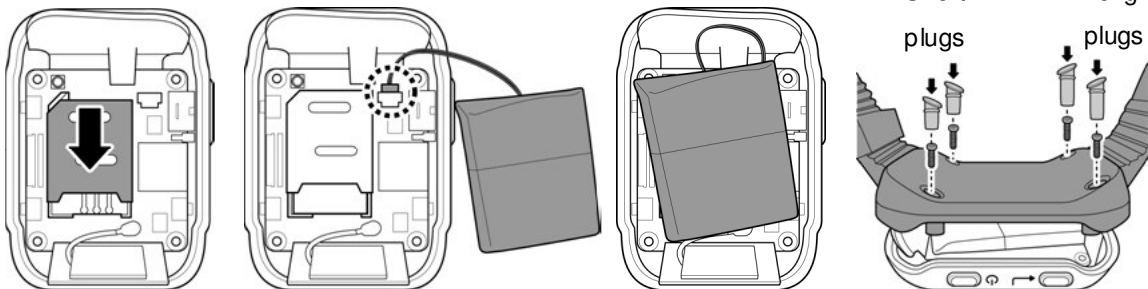



To Track:

1. Call the telephone number of the sim card you have placed in the watch from a mobile phone..
2. Make sure there is credit on the sim card!
3. The watch will disconnect your call.....
4. The watch will send your mobile phone a text message.
5. Wait for your text message (to the mobile from which you called from).
6. Open the text message in the mobile phone and ask to view it in your phones browser (setting on your mobile).
7. If the watch was able to get a location, a map will now download to your mobile phone.
8. If you watch does not have a GPS lock then, the text message will not have 2 long strings of numbers (normally starting with '51' and '03' and are the longitude and latitude co-ordinates) and you will not be able to download a map.